

**Gewindestopfen für Vierkantrohre**

**Threaded Bush for Square Tubes**

**Beschreibung** Kunststoff PA, mit Messing-Gewindeeinsatz zur Aufnahme von Stellfüßen an der Stirnseite von Vierkantrohren

**Material** Stopfen: Kunststoff PA, glasfaserverstärkt  
Gewindeeinsatz: Messing vernickelt

**Farbe** schwarz

**Liefereinheit** 10 Stück

**Extras** elektrostatisch ableitfähig, weitere Größen, weitere Farben auf Anfrage

**Description** Nylon PA, with Brass Threaded Insert To fit leveling feet to square, non-threaded tubes

**Material** Bush: Nylon PA, glass fibre reinforced  
Threaded insert: Nickel plated brass

**Color** Black

**Pack Quantity** 10 pieces

**Specials** electrostatically conductive, other sizes, other colors on request

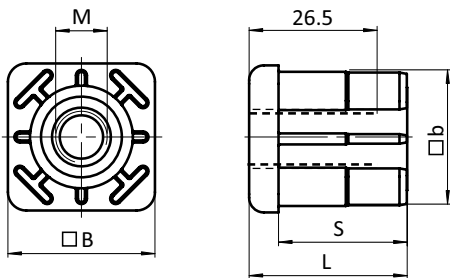

Gewindestopfen Threaded Bushes	Vierkantrohr [mm] Square Tube [mm]	M	B [mm]	b [mm]	L [mm]	S [mm]	Tragkraft [kg] Max. Load [kg]	Gewicht [g] Weight [g]	Teil-Nr. Part #
	30 x 30 x 1.5	M8	30	27.5	33	27	500	69.0	<a href="#">098V301508</a>
	30 x 30 x 1.5	M10	30	27.5	33	27	500	54.0	<a href="#">098V301510</a>
	30 x 30 x 1.5	M12	30	27.5	33	27	500	57.0	<a href="#">098V301512</a>
	30 x 30 x 1.5	M14	30	27.5	33	27	500	48.0	<a href="#">098V301514</a>
	30 x 30 x 1.5	M16	30	27.5	33	27	500	52.0	<a href="#">098V301516</a>
	30 x 30 x 2.0	M8	30	26.5	33	27	500	68.0	<a href="#">098V302008</a>
	30 x 30 x 2.0	M10	30	26.5	33	27	500	63.0	<a href="#">098V302010</a>
	30 x 30 x 2.0	M12	30	26.5	33	27	500	56.0	<a href="#">098V302012</a>
	30 x 30 x 2.0	M14	30	26.5	33	27	500	47.0	<a href="#">098V302014</a>
	30 x 30 x 2.0	M16	30	26.5	33	27	500	51.0	<a href="#">098V302016</a>
	40 x 40 x 1.5	M8	40	37.5	43	35	800	96.0	<a href="#">098V401508</a>
	40 x 40 x 1.5	M10	40	37.5	43	35	800	91.0	<a href="#">098V401510</a>
	40 x 40 x 1.5	M12	40	37.5	43	35	800	84.0	<a href="#">098V401512</a>
	40 x 40 x 1.5	M14	40	37.5	43	35	800	75.0	<a href="#">098V401514</a>
	40 x 40 x 1.5	M16	40	37.5	43	35	800	79.0	<a href="#">098V401516</a>
	40 x 40 x 1.5	M20	40	37.5	43	35	800	75.0	<a href="#">098V401520</a>
	40 x 40 x 2.0	M8	40	36.5	43	35	1000	93.0	<a href="#">098V402008</a>
	40 x 40 x 2.0	M10	40	36.5	43	35	1000	88.0	<a href="#">098V402010</a>
	40 x 40 x 2.0	M12	40	36.5	43	35	1000	81.0	<a href="#">098V402012</a>
	40 x 40 x 2.0	M14	40	36.5	43	35	1000	72.0	<a href="#">098V402014</a>
	40 x 40 x 2.0	M16	40	36.5	43	35	1000	76.0	<a href="#">098V402016</a>
	40 x 40 x 2.0	M20	40	36.5	43	35	1000	74.0	<a href="#">098V402020</a>
	40 x 40 x 2.5	M8	40	35.5	43	35	1000	93.0	<a href="#">098V402508</a>
	40 x 40 x 2.5	M10	40	35.5	43	35	1000	88.0	<a href="#">098V402510</a>
	40 x 40 x 2.5	M12	40	35.5	43	35	1000	81.0	<a href="#">098V402512</a>
	40 x 40 x 2.5	M14	40	35.5	43	35	1000	72.0	<a href="#">098V402514</a>
	40 x 40 x 2.5	M16	40	35.5	43	35	1000	76.0	<a href="#">098V402516</a>
	40 x 40 x 2.5	M20	40	35.5	43	35	1000	74.0	<a href="#">098V402520</a>
40 x 40 x 3.0	M8	40	34.5	43	35	1000	95.0	<a href="#">098V403008</a>	
40 x 40 x 3.0	M10	40	34.5	43	35	1000	90.0	<a href="#">098V403010</a>	
40 x 40 x 3.0	M12	40	34.5	43	35	1000	83.0	<a href="#">098V403012</a>	
40 x 40 x 3.0	M14	40	34.5	43	35	1000	74.0	<a href="#">098V403014</a>	