

UP. 22. MT

- Union
- BSP male thread

- Ecrrou
- Mâle à visser BSP

- Pezzo folle
- Filetto maschio BSP

- Bundbuchse
- Aussengewinde BSP

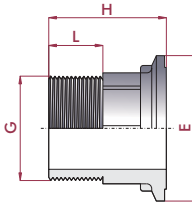

G	CODE	REF.	PN	L	H	E
3/8"	25959	05 22 416	10	12	33	24
1/2"	25960	05 22 420	10	15	38	30
3/4"	25961	05 22 425	10	16	41	39
1"	25962	05 22 432	10	19	48	45
1 1/4"	25963	05 22 440	10	21	50	57
1 1/2"	25964	05 22 450	10	21	57	63
2"	25965	05 22 463	10	28	70	78
2 1/2"	25966	05 22 475	10	30	72	97
3"	25967	05 22 490	10	33	77	110
4"	25968	05 22 510	10	40	98	147

UP. 22. SM

- Union
- Male solvent socket
- Metric series

- Ecrrou
- Mâle à coller
- Série métrique

- Pezzo folle
- Incollaggio maschio
- Serie metrica

- Bundbuchse
- Klebestutzen
- Metrische Serie

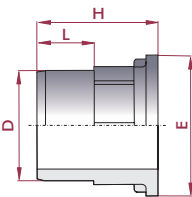

D	CODE	REF.	PN	L	H	E
50	25957	05 22 250	16	31	66	63
63	25958	05 22 263	16	38	80	78

UP. 23. FT

- Union nut
- BSP female thread

- Ecrrou
- Femelle à visser BSP

- Ghiera
- Filetto femmina BSP

- Überwurfmutter
- Innengewinde BSP

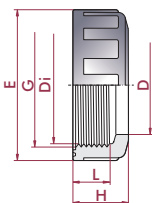

G	CODE	REF.	PN	L	H	E	D	Di
3/4"	02187	05 23 625	10	15	20	36	22	24
1"	02188	05 23 632	10	15	20	41	27	30
1 1/4"	02189	05 23 640	10	16	22	52	36	39
41,5	02190	05 23 641	10	12	18	53	33	39
1 1/2"	02191	05 23 650	10	20	26	60	41	45
2"	02192	05 23 663	10	21	26	74	53	57
2 1/4"	02193	05 23 664	10	22	30	80	59	63
56,5	02194	05 23 665	10	19	28	70	46	54
70,0	02195	05 23 675	10	18	27	90	64	72
2 3/4"	02196	05 23 676	10	28	36	99	74	78
3 1/2"	02197	05 23 692	10	28	36	120	92	97
4"	02198	05 23 710	10	28	38	133	105	110
5 1/2"	02199	05 23 741	10	41	56	177	131	148